



Modular Heavy Load Grippers

- two to six finger gripper, machine elements for self-constructions-

Characteristics:

- inside and outside gripping applications
- parallel finger movement
- use of long fingers in various positions (fingers optional)
- long stroke with end-of-stroke damping on both sides
- high grip forces, optionally with object retention upon loss of air pressure
- high torques in all three directions
- short cycle time (under 2 s)
- compact design, low self-weight
- continuous hollow center
- maintenance- and lubrication-free slide bearings
- multiple position checks through proximity switches (optional)

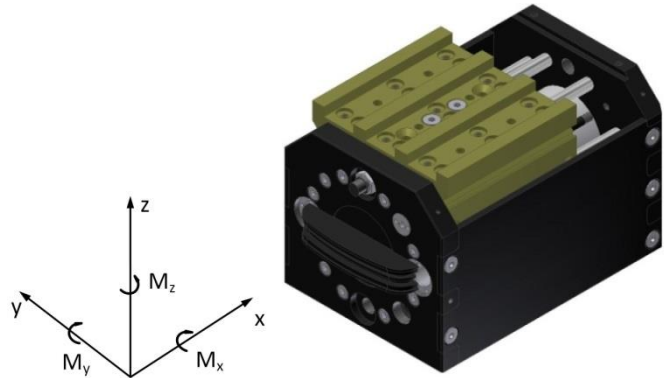

image: single module

Technical specifications						
Gripper type		Sx10	S210	S310	S410	S610
Stroke per finger	[mm]	70				
Gripping force per Finger (bei 6 bar)	[N]	1.700				
Drive		pneumatic cylinder				
Operating pressure	[bar]	2,5 bis 10				
Cycle time (damped)	open	1 (at 6 bar)				
	close	1 (at 6 bar)				
Operating temperature	[°C]	-30 to +80				
Mass	[kg]	12	29	47	65	106
Load capacity per finger due to object mass and Acceleration	$M_{x \max.}$	500				
	$M_{y \max.}$ (gripping)	850*				
	$F_{z \max.}$	30.000				
	$M_{z \max.}$	850				
*) reached at	Length of finger	500	250	166	125	166
	Pressure	6				
	Plane / Direction	horizontal y-z-plane	horizontal y-z-plane	horizontal z-axis	horizontal z-axis	horizontal z-axis
max. load at this position	[N]	1.700	3.400	5.100	6.800	10.200



GMG
Gesellschaft fuer modulare Greifersysteme mbH
Coesterweg 45c
D-59494 Soest (Germany)

phone: +49 (0)2921 – 4062
e-mail: info@gmg-system.com
homepage: http://www.gmg-system.com

Type variants

2 finger, parallel

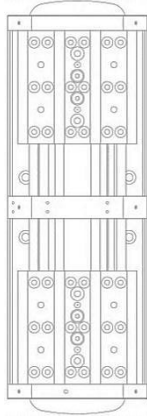

S210

3 finger, centric

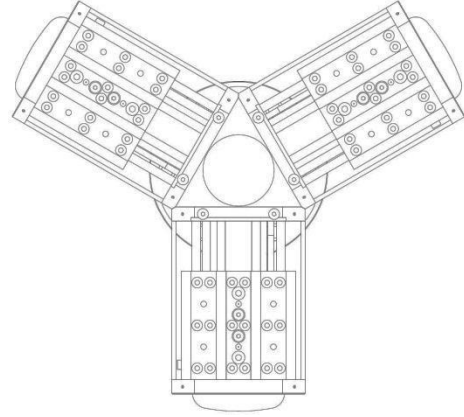

S310

4 finger, centric

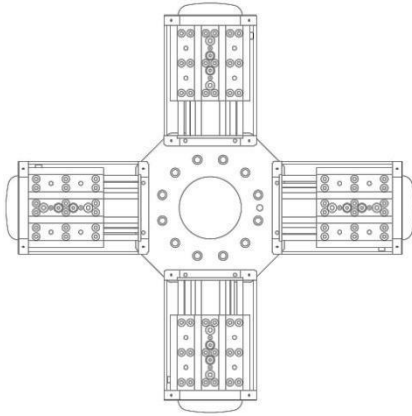

S410

4 finger, parallel

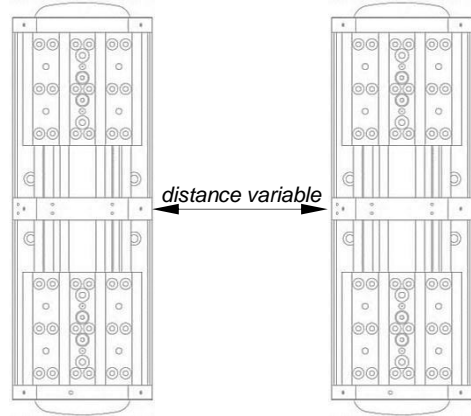

S411

6 finger, centric

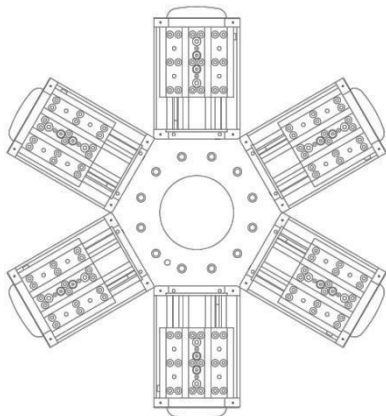

S610

6 finger, parallel

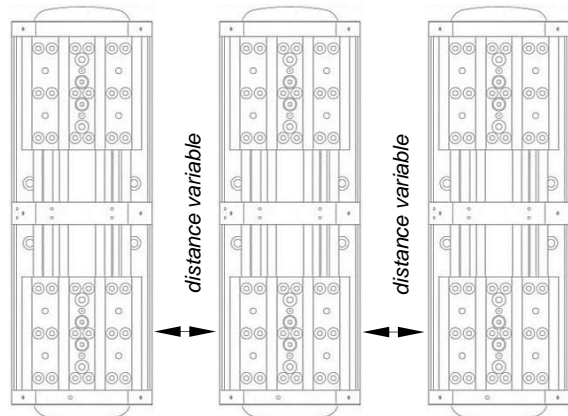

S611

Single Module Sx10
Dimension Sheet

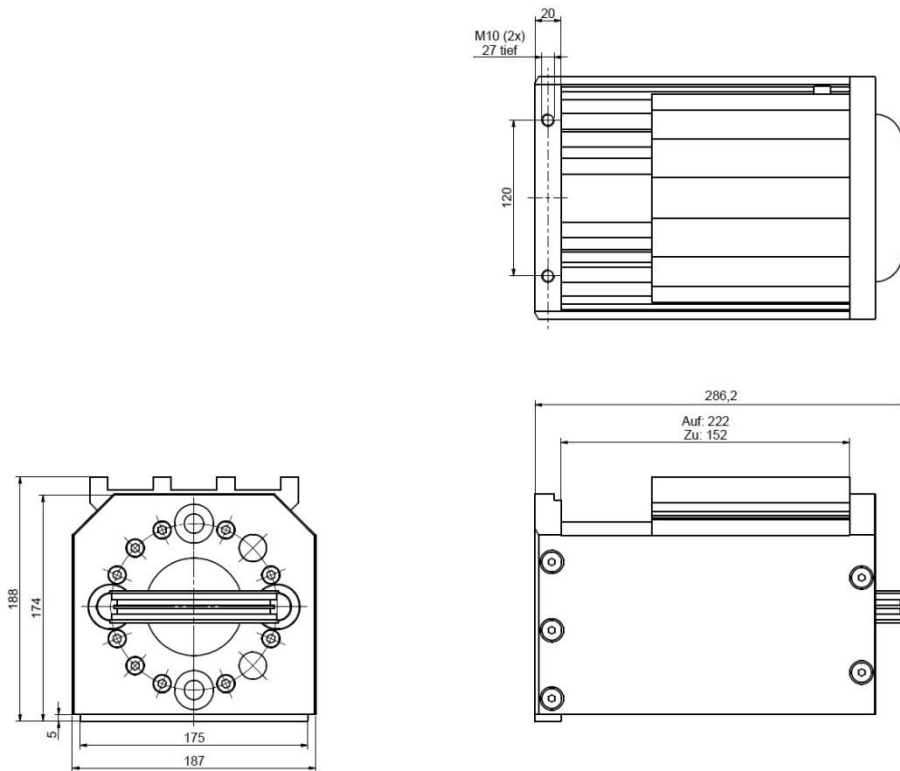

Connection holes for fingers
(applies to all types of this series)

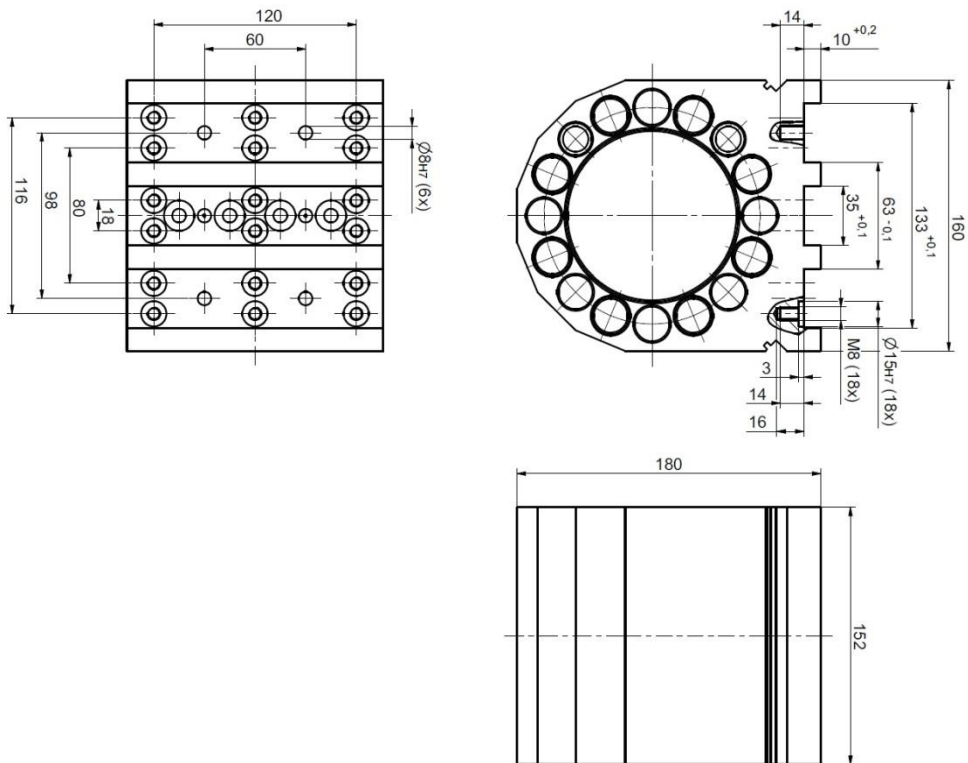



2-Finger Heavy Load Parallel Gripper Type S210

Dimension sheet

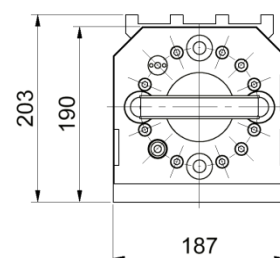
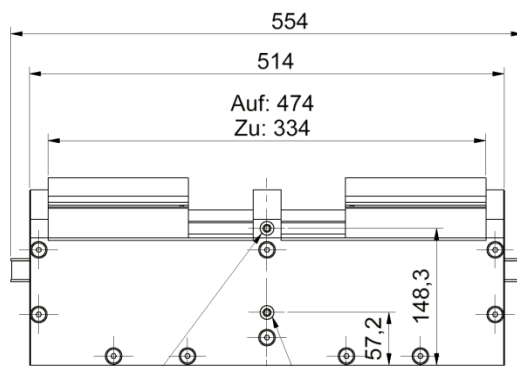
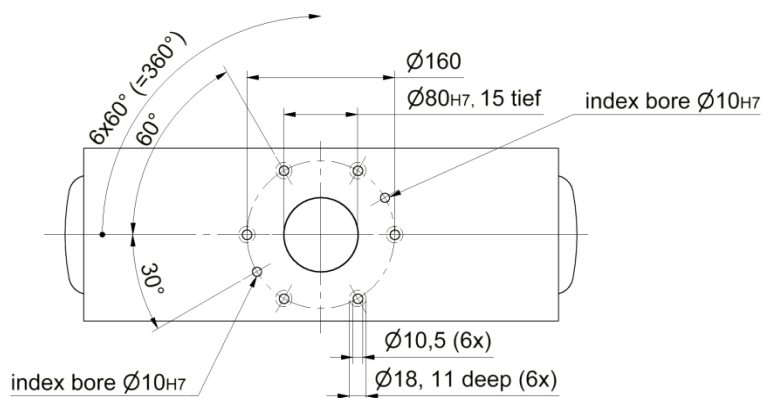

pneumatic connection "OPEN" G1/8", 6 deep

pneumatic connection "CLOSE" G1/8", 10 deep



GMG
Gesellschaft fuer modulare Greifersysteme mbH
Coesterweg 45c
D-59494 Soest (Germany)

phone: +49 (0)2921 – 4062
e-mail: info@gmg-system.com
homepage: <http://www.gmg-system.com>

3-Finger Heavy Load Centric Gripper Type S310

Dimension sheet

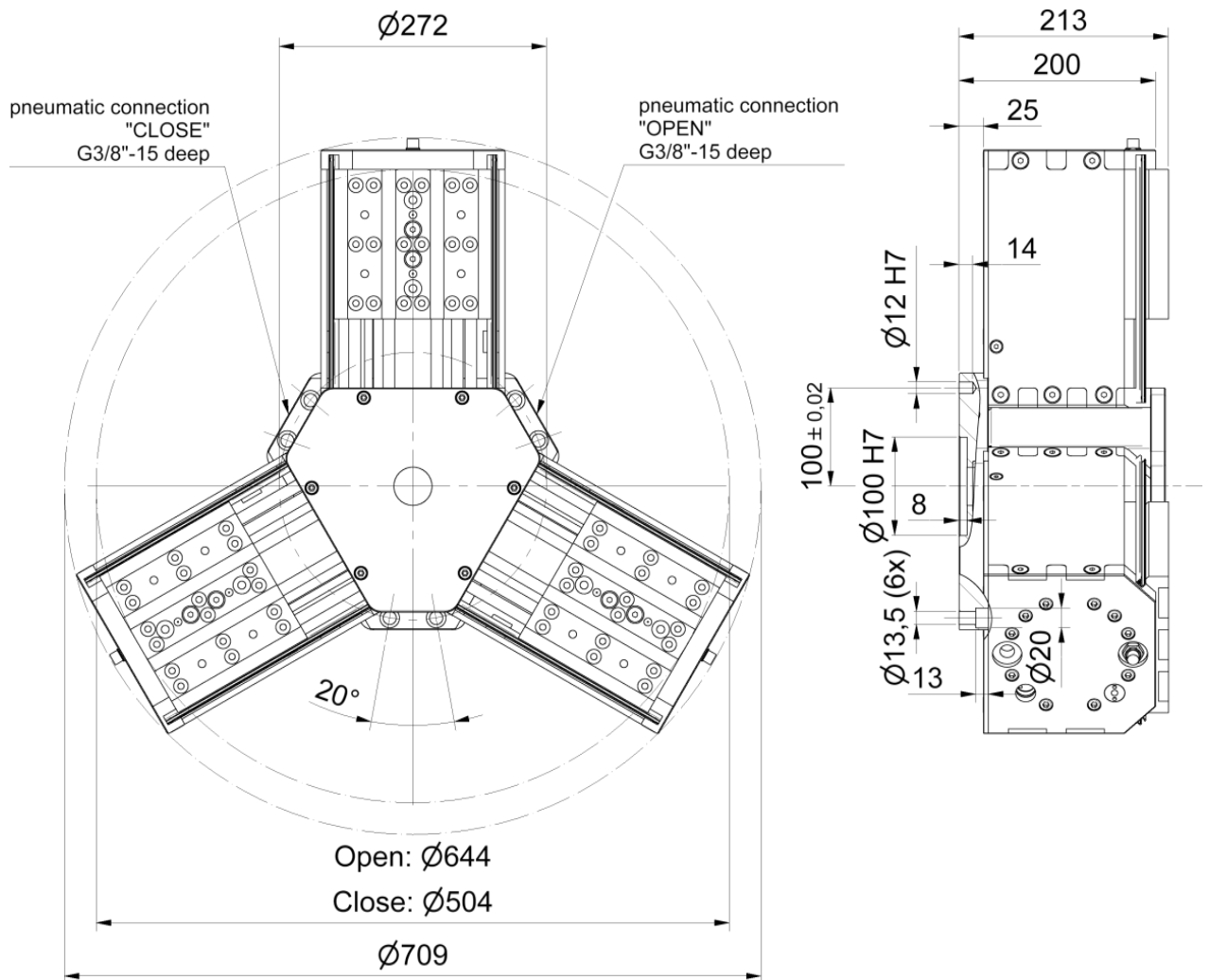

4-Finger Heavy Load Centric Gripper Type S410

Dimension sheet

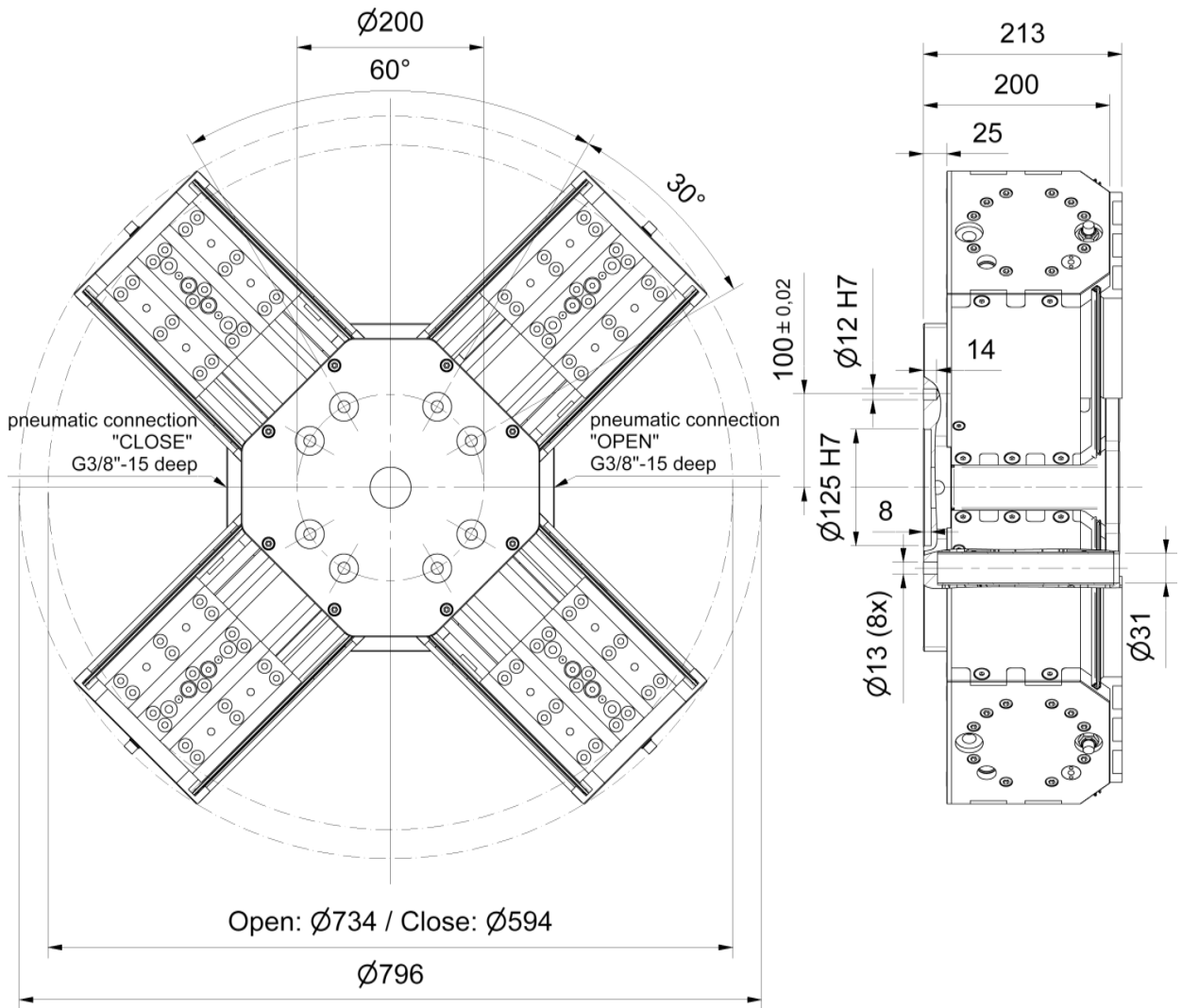

6-Finger Heavy Load Centric Gripper Type S610

Dimension sheet

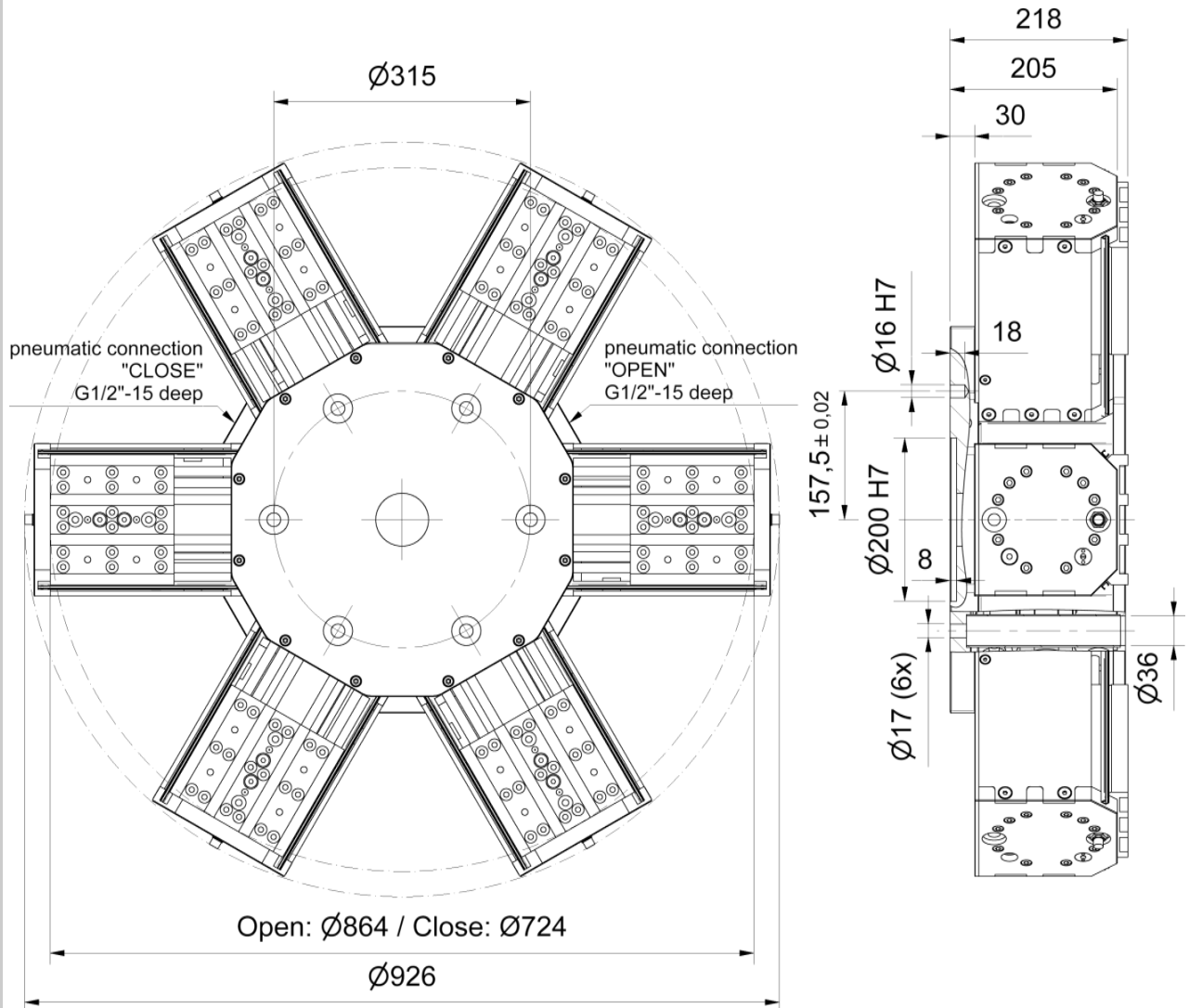



Order Number

S x 1 0 - P N - 0 0

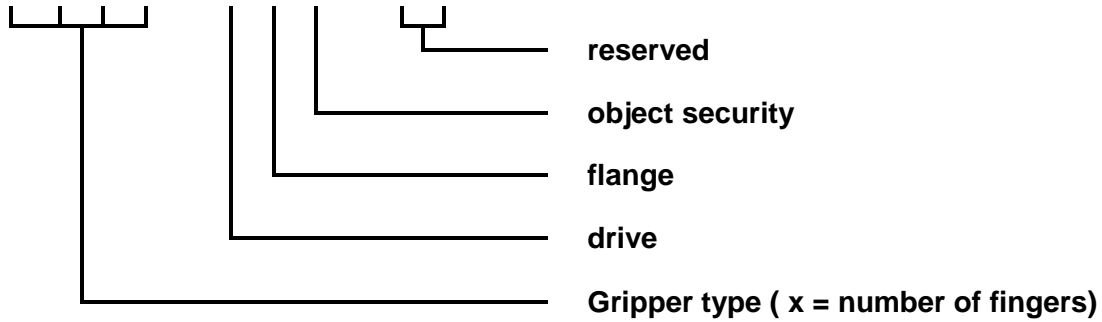

Drive	
style	ident
pneumatic	P

Flange	
style	ident
flange	N

Object Security	
style	ident
without object security	O
Fingers closing	Z
Fingers opening	A

